



MIDLAND MAIN LINE

NOTTINGHAM – LINCOLN



ROUTE GUIDE

Just Trains

Just Trains' Midland Main Line route and extensions



Midland Main Line: Sheffield-Derby



Derwent Valley Line



*Derby-Nottingham-Leicester
Extension*



Erewash Valley



*Barrow Hill Roundhouse
Extension*

Just Trains™

www.justtrains.net

MIDLAND MAIN LINE

NOTTINGHAM – LINCOLN

Route Guide

Route expansion for Train Simulator

CONTENTS

INTRODUCTION	4
Train Simulator requirements.....	5
Scenery quality and display settings.....	5
Run in 64-bit mode!.....	5
INSTALLATION, UPDATES AND SUPPORT	6
STATIONS	7
FEATURES TO LOOK OUT FOR ON THE ROUTE	15
SCENARIOS	30
Standard scenarios requiring additional payware add-ons	31
Standard scenarios using default Train Simulator stock.....	34
Free Roams	35
QUICK DRIVE	36
CREDITS	38
COPYRIGHT	38

INTRODUCTION

This Nottingham-Lincoln route runs from Nottingham in the west to Lincoln in the east and is approximately 36 miles in length. The route is Quick Drive enabled and includes 15 detailed stations along with numerous new custom assets along the length of the route.

Eight scenarios which require additional payware add-ons are included as well as eight scenarios which only require the default Train Simulator stock. See the [SCENARIOS](#) section for all the details.



Train Simulator requirements

If you purchased Train Simulator after 20 September 2012 you will require the European Loco & Asset Pack (available to purchase via [Steam](#)) for this route to display correctly and for some scenarios to work.

Some of the scenarios supplied with this Nottingham-Lincoln route require add-ons which are not supplied with this software; see the [SCENARIOS](#) section for full details.

Scenery quality and display settings

Various effects and techniques have been used to enhance the realism of this route, including TSX technology for realistic night lighting effects.

We recommend running the route with 'Procedural Flora' turned off via Settings > Graphics > Advanced > Next and then Save.

Due to the high level of detail which has been modelled, it is best to run the route at the highest settings your PC can manage. Settings can all be accessed via the Settings > Graphics menu in Train Simulator. The route will still run at lower settings, of course, but some of the assets may not be displayed as intended.

Run in 64-bit mode!

We strongly advise you to run Train Simulator in 64-bit mode to enhance its stability:

1. Run the Steam client and select 'Games' from the top menu.
2. Select 'Train Simulator' from the left-side menu and press the blue 'PLAY' button in the top centre of the window. The option to 'Play Train Simulator' or 'Play Train Simulator 64-bit Edition' will pop up.
3. Select the 64-bit option and press 'Play'.



INSTALLATION, UPDATES AND SUPPORT

You can install this add-on as often as you like on the same computer system. To re-download the Nottingham-Lincoln software:

1. Click on the 'Account' tab on the [Just Trains](#) website.
2. Log in to your account.
3. Click on the 'Your Orders' button.
4. A list of your purchases will appear and you can then re-download the software you require.

Uninstalling

To uninstall this product from your system, select the appropriate option for your version of Windows from the Control Panel:

- 'Add or Remove Programs' (Windows XP)
- 'Programs and Features' (Windows Vista or 7)
- 'Apps & features' (Windows 10 or later)

Choose the product you want to uninstall and then select the 'Uninstall' option; follow the on-screen instructions to uninstall the software.

Uninstalling or deleting this software in any other way may cause problems when using this product in the future or with your Windows set-up.

Updates and Technical Support

For technical support (in English) please visit the [Support](#) pages on the Just Trains website.

As a Just Trains customer you can obtain free technical support for any Just Trains product.

If an update becomes available for this software, we will post details on the Support page and will also send a notification email about it to all buyers who have not unsubscribed from our emails.

Regular News

To get all the latest news about Just Trains products, special offers and projects in development, [sign up](#) for our regular emails.

We can assure you that none of your details will ever be sold or passed on to any third party and you can, of course, unsubscribe from this service at any time.

You can also keep up to date with Just Trains via [Facebook](#) and [Twitter](#).

STATIONS

Nottingham



Opened 1848

Passengers 2019-2020: 7.865 million

Netherfield



Opened 1850

Passengers 2019-2020: 8,292

Carlton



Opened 1846

Passengers 2019-2020: 57,552

Burton Joyce

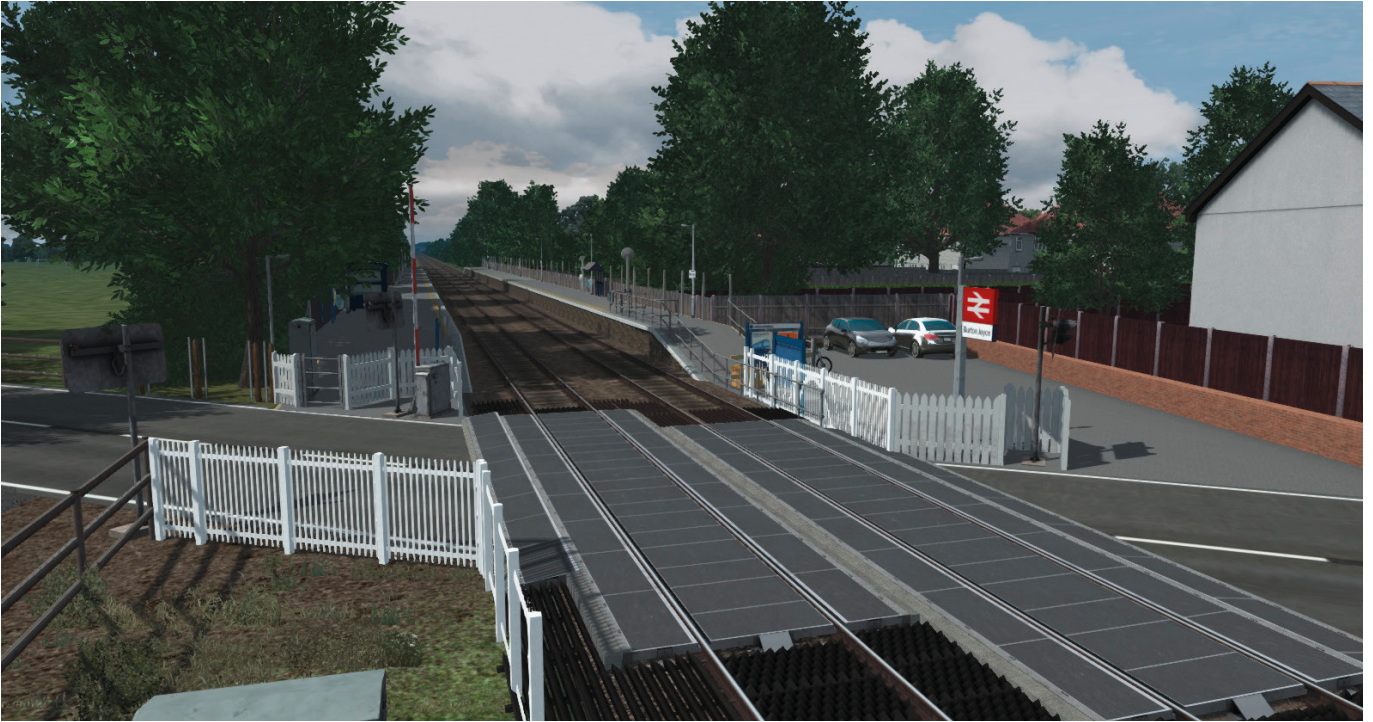

Opened 1846

Passengers 2019-2020: 15,330

Lowdham



Opened 1846

Passengers 2019-2020: 70,442

Thurgarton



Opened 1846

Passengers 2019-2020: 4,338

Bleasby



Opened 1846

Passengers 2019-2020: 8,688

Fiskerton

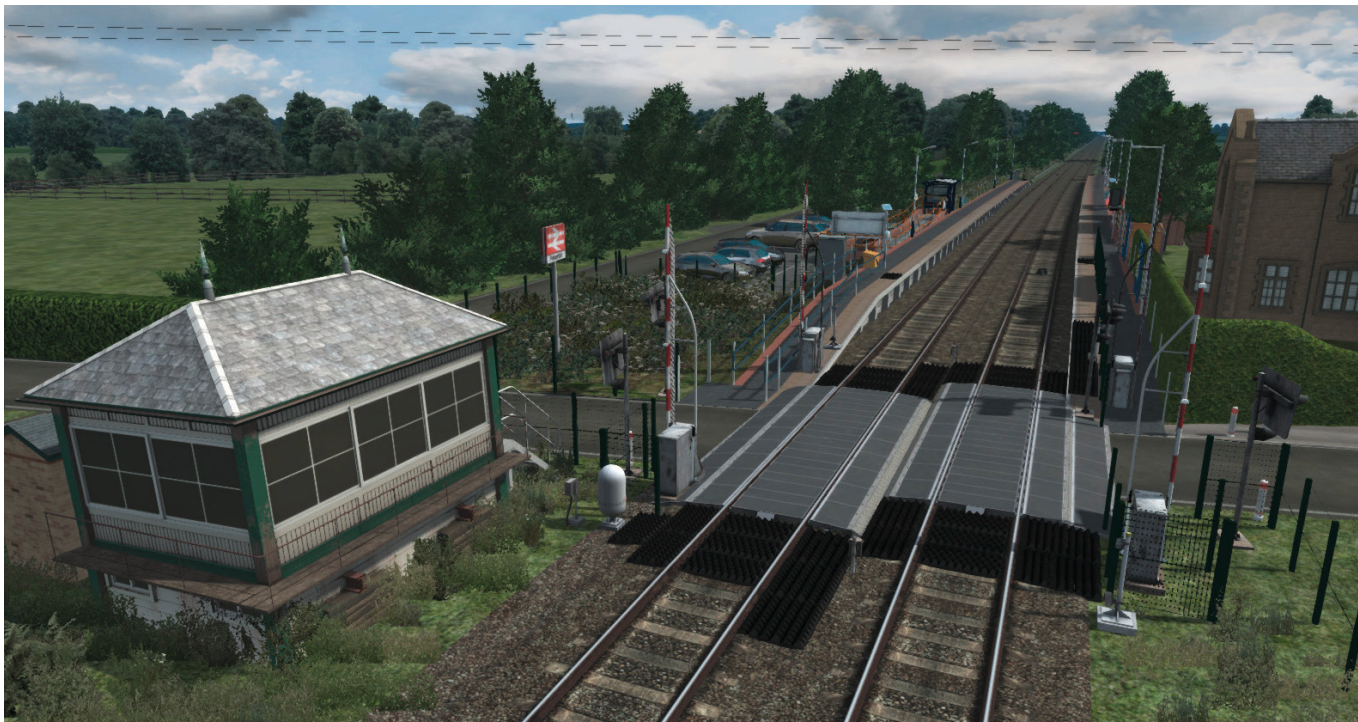

Opened 1846

Passengers 2019-2020: 36,708

Rolleston

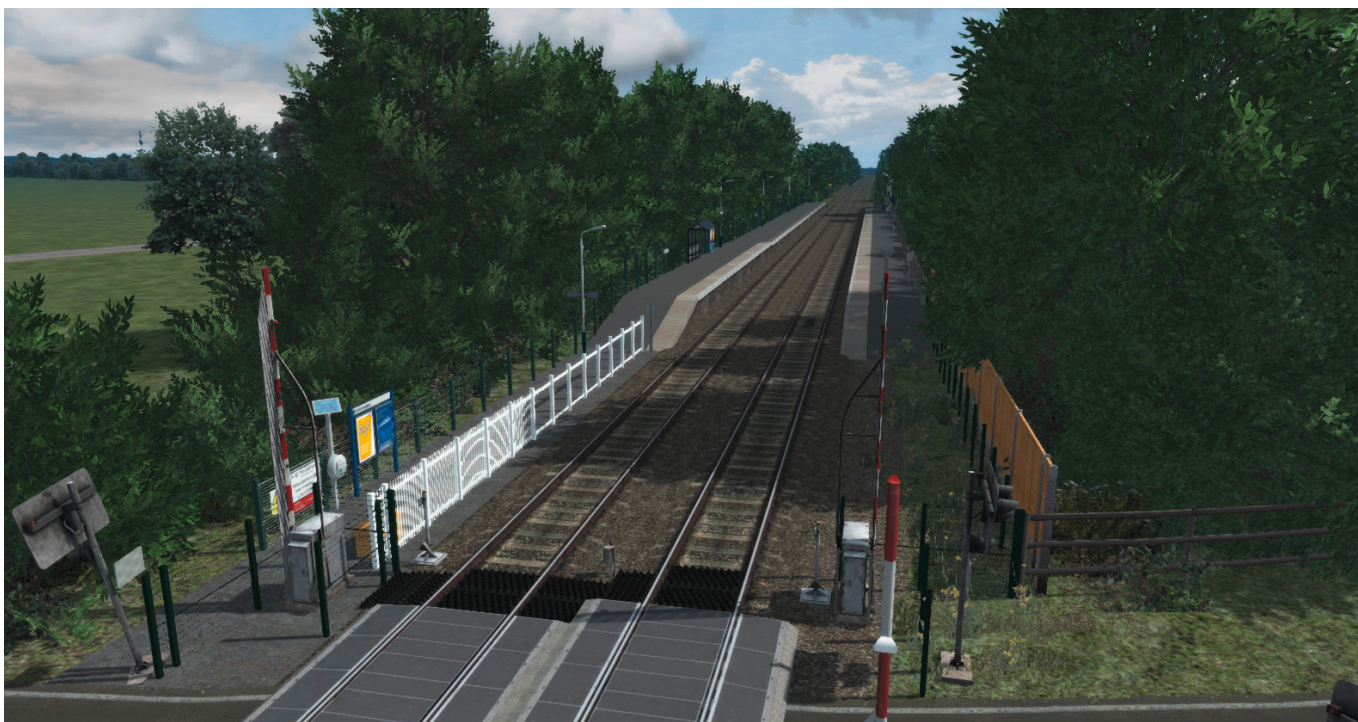

Opened 1846

Passengers 2019-2020: 5,408

Newark Castle



Opened 1859

Passengers 2019-2020: 0.760 million

After Newark Castle station the line crosses the East Coast Main Line. On the south side of this line lies Newark Northgate station.

Newark Northgate



Opened 1852

Passengers 2019-2020: 0.910 million

Collingham



Opened 1846

Passengers 2019-2020: 128,032

Swinderby



Opened 1846

Passengers 2019-2020: 17,912

Hykeham



Opened 1846

Passengers 2019-2020: 0.183 million

Lincoln



Opened 1848

Passengers 2019-2020: 1.966 million

FEATURES TO LOOK OUT FOR ON THE ROUTE

Landmark buildings and other features of interest have been modelled along the length of the route – these are some of them, listed in the order you'd see them when driving from Nottingham to Lincoln:

Colwick Woods Court



This residential tower block is the joint 23rd tallest building around Nottingham.

Netherfield Junction

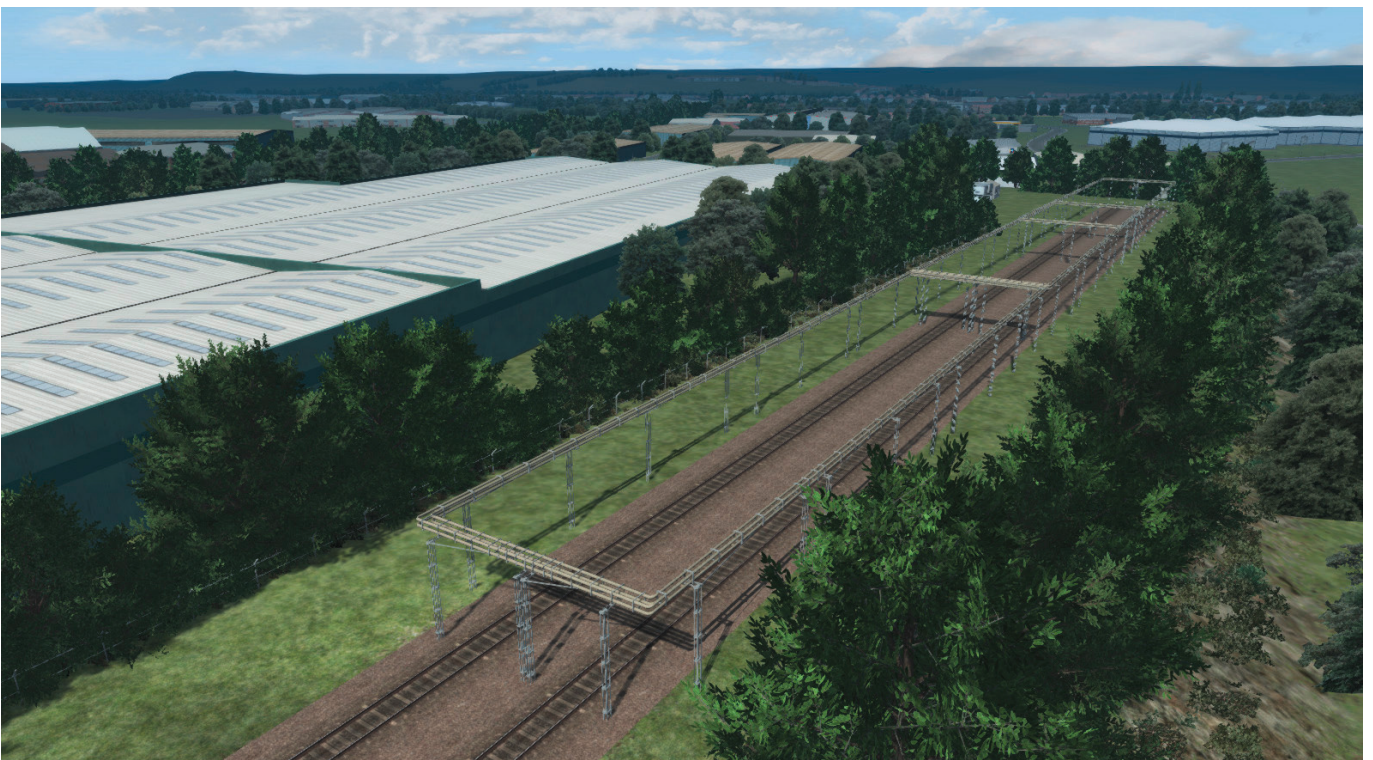

This spur off to the right takes the line towards Grantham and eventually to Skegness. Just after the spur are the sidings for the Colwick oil terminal.

Forterra building supplies

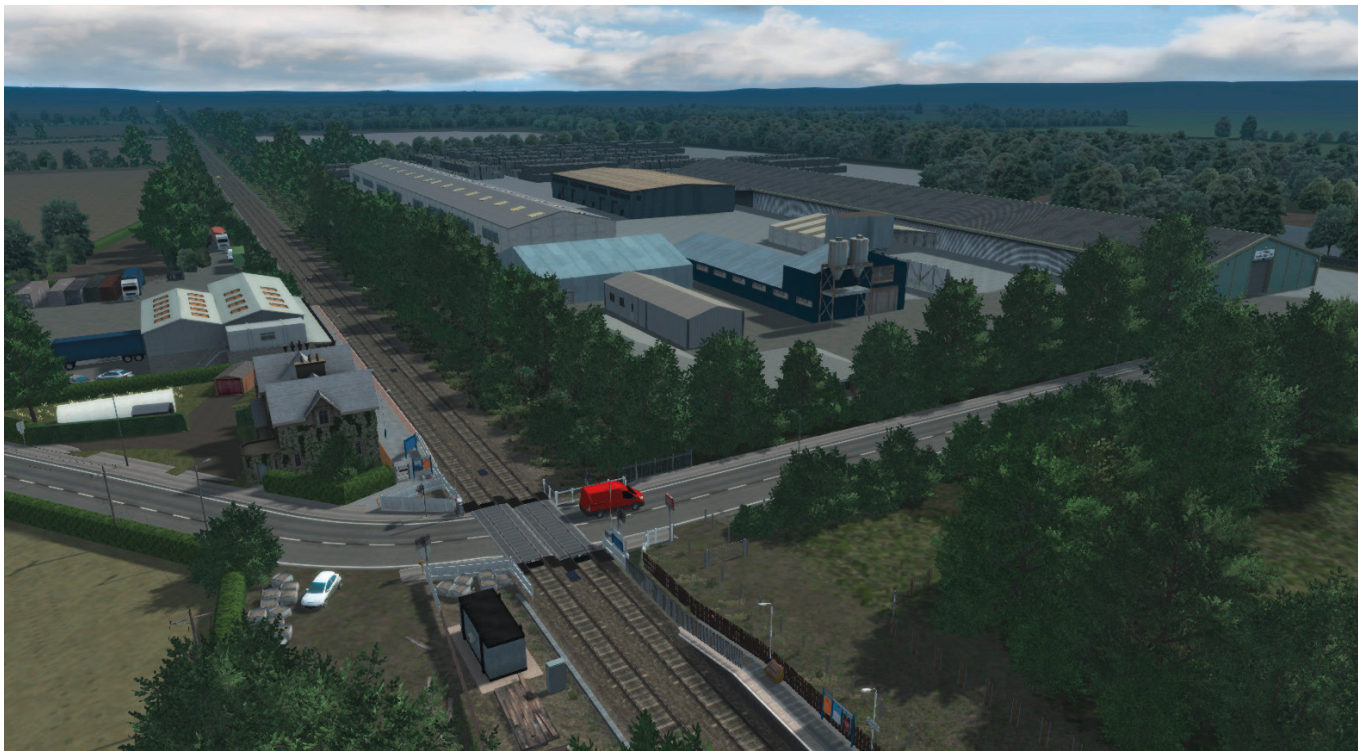

This warehouse is home to a building materials supplier.

Fiskerton Junction signal box

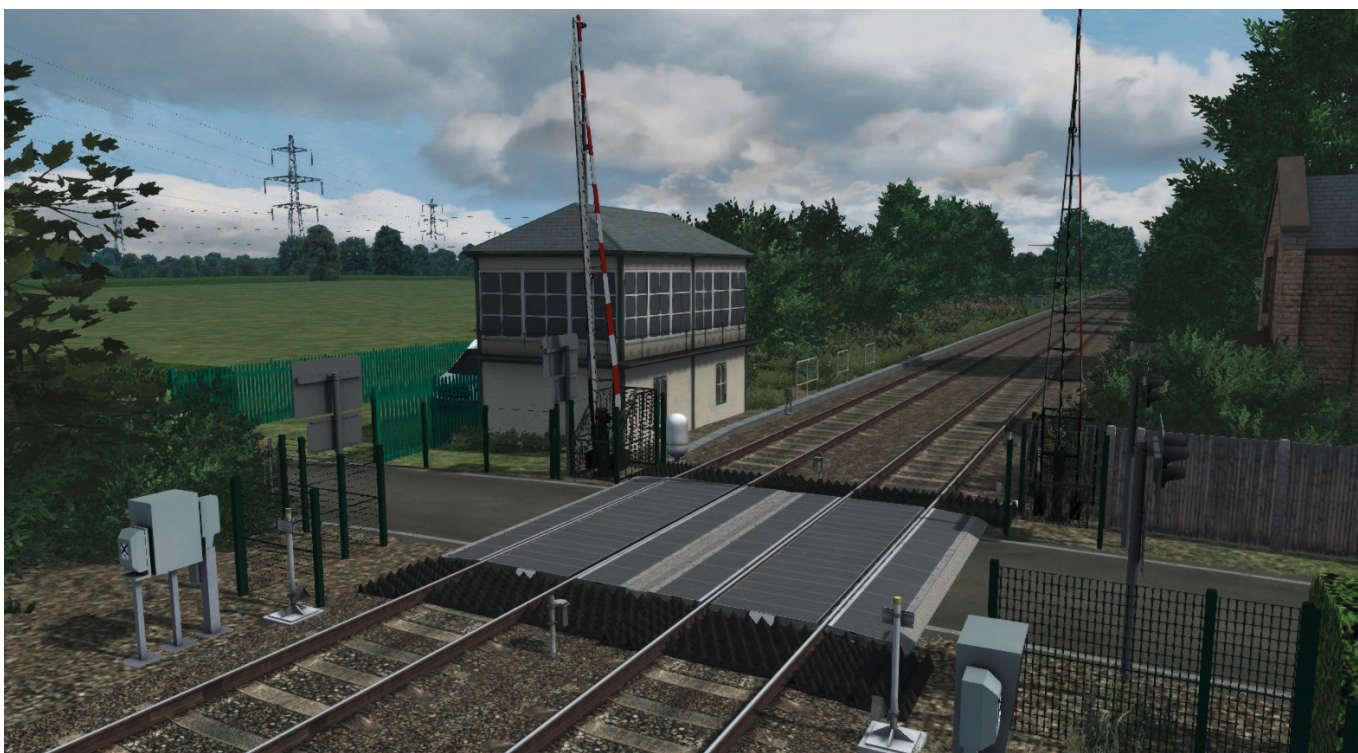

Opened in 1929 and closed in 2015, Fiskerton was one of the last Midland Railway-style boxes built by the LMS.

Staythorpe Crossing box



The signal box at Staythorpe stands next to the level crossing which it controlled until November 2016; it was then closed when control of the Nottingham-Newark line passed to the Derby Signalling Centre.

Staythorpe Power Station



Staythorpe C Power Station is a 1,735 MWe gas-fired power station. It is the second largest Combined Cycle Gas Turbine (CCGT) power station in the UK.

Staythorpe Viaduct



This carries the line over the River Trent.

Newark Castle



This castle dates from around 1135.

Newark auction house



This is one of several auction houses in the area.

Newark British Sugar



Sugar beet is brought to this factory to be turned into sugar.

Nether Lock Viaduct

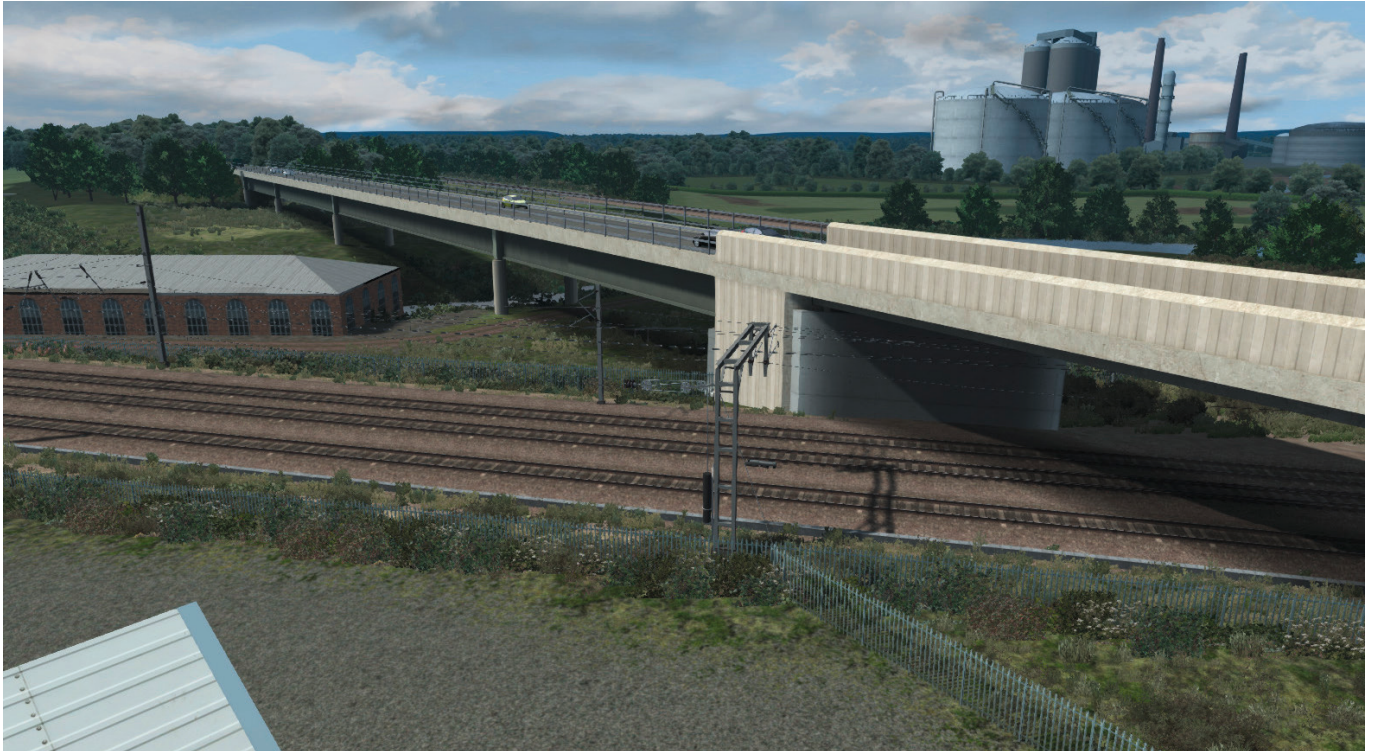

This carries the A46 road over the River Trent.

Newark flat crossing



This is the only standard gauge flat crossing in the UK and where the Nottingham-Lincoln line crosses the East Coast Main Line.

Swinderby signal box



This signal box is now a Grade II listed building.

Lindum building



This warehouse houses a construction business.

Boultham Junction



At this junction the line goes left towards Gainsborough and right towards Lincoln.

Lincoln Signalling Control Centre



This centre replaces four individual signal boxes.

West Holmes Junction



This is where the line from Nottingham joins the line to Lincoln and the line from Lincoln heads left towards Gainsborough.

University of Lincoln

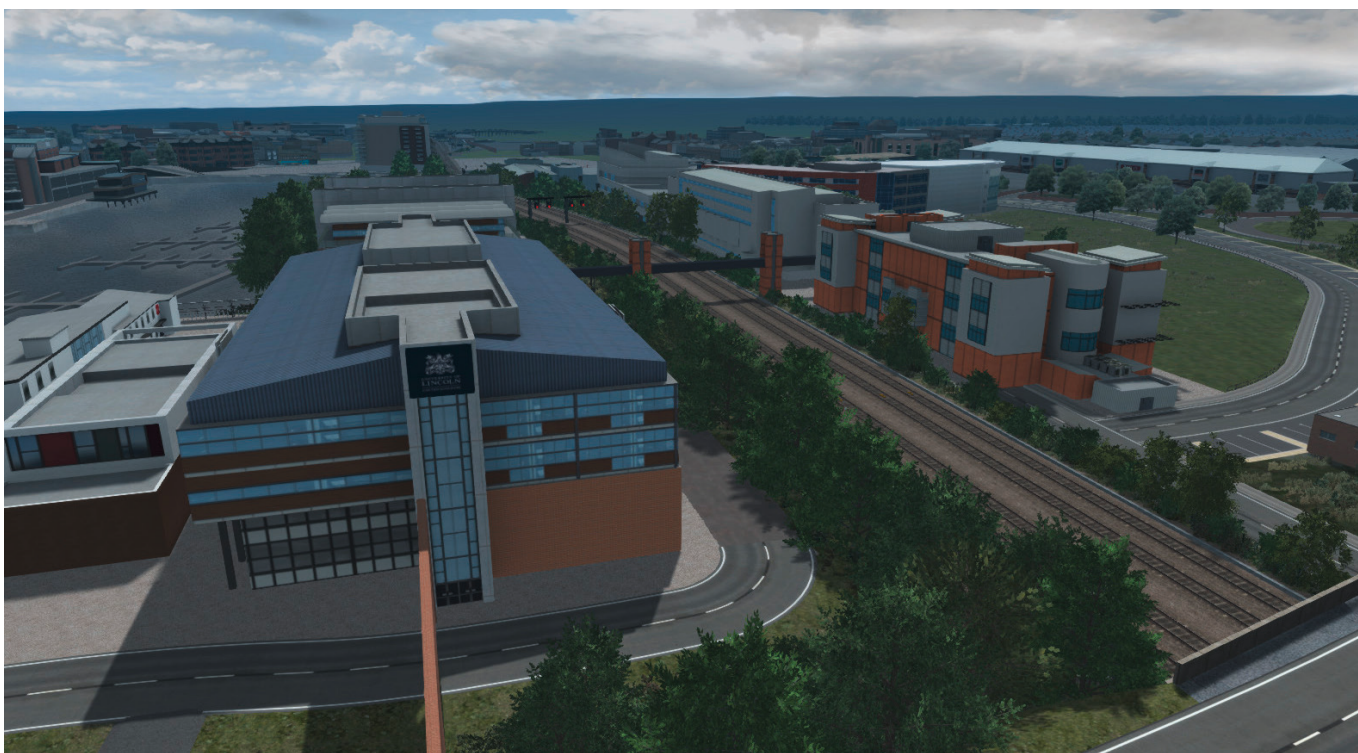

These buildings make up part of the University of Lincoln.

Brayford Pool



Located near the centre of Lincoln, where the River Witham meets the Fossdyke Canal, is Brayford Pool, reputedly the oldest inland harbour in England and dating back to Roman times. There are numerous restaurants and facilities on the quayside.

East Holmes signal box



East Holmes signal box was opened by the Great Northern Railway in May 1873. It is the second oldest GNR box to survive and a Grade II listed building.

Lincoln Castle



Lincoln Castle is a major Norman castle which was built during the late 11th century by William the Conqueror on the site of a pre-existing Roman fortress. The castle is unusual in that it has two mottes.

Lincoln High Street signal box



This signal box was built by the Great Northern Railway in 1874. It is an early surviving example of a GNR box and now a Grade II listed building.

Lincoln Cathedral



Lincoln Cathedral, Lincoln Minster, or the Cathedral Church of the Blessed Virgin Mary of Lincoln and sometimes St Mary's Cathedral is the seat of the Anglican Bishop of Lincoln. Construction began in 1072 and continued in several phases throughout the High Middle Ages.

Lincoln central bus station



Lincoln central bus and coach station handles 650 bus departures each day. The station is part of the Lincoln Transport Hub complex south of the city centre which also includes Lincoln Central railway station and a large car parking complex.

Siemens energy works



Siemens has a large industrial presence in Lincoln.

Pelham Street Junction



This junction takes the line towards Barnetby.

Stagecoach bus depot sidings



From here the line continues towards Peterborough.

SCENARIOS

Choosing a scenario

When you first start Train Simulator, select the 'Drive' option in the Main Menu, then choose the Standard scenarios.

Use the scroll bar on the right side to scroll down to 'Just Trains – Nottingham-Lincoln'.

You can now choose your scenario and click on the 'Go' button.

Eight scenarios are included which require additional payware content.

Eight scenarios are included which only require default Train Simulator stock and the European Loco and Asset pack; these are prefixed with **[Default]**.

The add-on requirements for each scenario are listed in the descriptions, but here's a list of all the add-ons required to operate those scenarios which require additional payware stock.

Just Trains

- [Class 222 Advanced 2019](#)
- [Class 153 DMU Advanced](#)

Steam

- [BR Class 170 'Turbostar' DMU Add-On](#)
- [Network SouthEast Class 159 DMU Add-On](#)
- [EWS Class 66 v2.0 Loco Add-On](#)
- [Freightliner Class 70 Loco Add-On](#)
- [Settle to Carlisle Route Add-On](#)
- [LNER BR Class 43 'High Speed Train' Remastered Loco Add-On](#)

Armstrong Powerhouse

- [Class 156 Diesel Multiple Unit Pack](#)
- [Class 168/170/171 Enhancement Pack](#)
- [Class 158/159 \(Cummins\) Enhancement Pack](#)
- [Class 43 \(VP185\)/Mk3 Enhancement Pack](#)
- [Class 66 Enhancement Pack](#)
- [JNA-C Wagon Pack](#)
- [Class 43 \(MTU\)/Mk3 Enhancement Pack](#)

Standard scenarios requiring additional payware add-ons

2A46 14:39 Newark Castle – Matlock

Drive a single Class 153 DMU from Newark Castle to Matlock.

Difficulty: Easy | Duration: 40 minutes

Requirements:

Armstrong Powerhouse

- Class 156 Diesel Multiple Unit Pack
- Class 158/159 (Cummins) Enhancement Pack

Just Trains

- Class 153 DMU Advanced
- Class 222 Advanced 2019

Steam

- Network SouthEast Class 159 DMU Add-On

2N31 10:37 Matlock – Newark Castle

Join 158773 at Nottingham, working 2N31 to Newark Castle.

Difficulty: Easy | Duration: 35 minutes

Requirements:

Armstrong Powerhouse

- Class 158/159 (Cummins) Enhancement Pack
- Class 156 Diesel Multiple Unit Pack

Steam

- Network SouthEast Class 159 DMU Add-On

2L60 10:36 Lincoln – Leicester

Take control of the 10:36 East Midlands Trains service to Leicester.

Difficulty: Easy | Duration: 60 minutes

Requirements:

Armstrong Powerhouse

- Class 158/159 (Cummins) Enhancement Pack
- Class 156 Diesel Multiple Unit Pack

Just Trains

- Class 153 DMU Advanced
- Class 222 Advanced 2019

Steam

- Network SouthEast Class 159 DMU Add-On

2L75 15:30 Leicester – Sleaford

Drive an East Midlands Trains Class 156, working 2L75 from Leicester to Lincoln.

Difficulty: Easy | Duration: 50 minutes

Requirements:

Armstrong Powerhouse

- Class 156 Diesel Multiple Unit Pack
- Class 43 (VP185)/Mk3 Enhancement Pack
- Class 66 Enhancement Pack
- Class 168/170/171 Enhancement Pack
- Class 158/159 (Cummins) Enhancement Pack

Just Trains

- Class 153 DMU Advanced

Steam

- EWS Class 66 v2.0 Loco Add-On
- BR Class 170 'Turbostar' DMU Add-On
- Network SouthEast Class 159 DMU Add-On
- Freightliner Class 70 Loco Add-On

6M00 14:30 Humber – Kingsbury

Drive 66098 from Lincoln to Nottingham, where a crew change will take place.

Difficulty: Medium/Hard | Duration: 65 minutes

Requirements:

Armstrong Powerhouse

- Class 66 Enhancement Pack
- Class 156 Diesel Multiple Unit Pack

Just Trains

- Class 153 DMU Advanced
- Class 222 Advanced 2019

Steam

- EWS Class 66 v2.0 Loco Add-On
- Freightliner Class 70 Loco Add-On
- Settle to Carlisle Route Add-On

1Z13/1Z14 Lincoln to Newark Shuttle

Drive 43045 + 43081 to Newark Northgate on 1Z13, then return to Lincoln with 1Z14.

Difficulty: Medium | Duration: 55 minutes

Requirements:

Armstrong Powerhouse

- Class 43 (VP185)/Mk3 Enhancement Pack
- Class 158/159 (Cummins) Enhancement Pack
- Class 156 Diesel Multiple Unit Pack
- Class 43 (MTU)/Mk3 Enhancement Pack

Just Trains

- Class 153 DMU Advanced
- Class 222 Advanced 2019

Steam

- Network SouthEast Class 159 DMU Add-On

5Z11/1Z12 Lincoln to Nottingham Shuttle

Good morning, driver. Today the Christmas markets are taking place in Lincoln. You have been tasked with using this High Speed Train set to run an additional service to help with capacity. First, prepare your cab ready for departure here at Lincoln. You'll be running empty to Nottingham and then return with 1Z12 which is a non-stop run between Nottingham and Lincoln. Have a safe trip!

Difficulty: Medium | Duration: 115 minutes

Requirements:

Armstrong Powerhouse

- Class 156 Diesel Multiple Unit Pack
- Class 158/159 (Cummins) Enhancement Pack
- Class 168/170/171 Enhancement Pack
- Class 43 (VP185)/Mk3 Enhancement Pack
- Class 43 (MTU)/Mk3 Enhancement Pack

Just Trains

- Class 222 Advanced 2019
- Class 153 DMU Advanced

Steam

- Network SouthEast Class 159 DMU Add-On
- BR Class 170 'Turbostar' DMU Add-On

1B81 07:30 Lincoln – London Kings Cross

Drive 43290 + 43308 on the morning southbound Lincoln to London Kings Cross service.

Difficulty: Easy | Duration: 27 minutes

Requirements:

Armstrong Powerhouse

- Class 156 Diesel Multiple Unit Pack
- Class 66 Enhancement Pack
- JNA-C Wagon Pack

Just Trains

- Class 153 DMU Advanced

Steam

- LNER BR Class 43 'High Speed Train' Remastered Loco Add-On
- EWS Class 66 v2.0 Loco Add-On
- Freightliner Class 70 Loco Add-On

Standard scenarios using default Train Simulator stock

No additional payware add-ons are needed for these scenarios to operate correctly.

[Default] 2A46 14:39 Newark Castle – Matlock

Drive a DMU from Newark Castle to Matlock.

Difficulty: Easy | Duration: 40 minutes

[Default] 2N31 10:37 Matlock – Newark Castle

Join your unit at Nottingham, working 2N31 to Newark Castle.

Difficulty: Easy | Duration: 35 minutes

[Default] 2L60 10:36 Lincoln – Leicester

Take control of the 10:36 East Midlands Trains service to Leicester.

Difficulty: Easy | Duration: 60 minutes

[Default] 2L75 15:30 Leicester – Sleaford

Drive a DMU working 2L75 from Leicester to Lincoln.

Difficulty: Easy | Duration: 50 minutes

[Default] [NL] 6M00 14:30 Humber – Kingsbury

Drive from Lincoln to Nottingham, where a crew change will take place.

Difficulty: Medium/Hard | Duration: 65 minutes

[Default] [NL] 1Z13/1Z14 Lincoln to Newark Shuttle

Drive an HST to Newark Northgate on 1Z13, then return to Lincoln with 1Z14.

Difficulty: Medium | Duration: 55 minutes

[Default] [NL] 5Z11/1Z12 Lincoln to Nottingham Shuttle

Good morning, driver. Today the Christmas markets are taking place in Lincoln. You have been tasked with using this High Speed Train set to run an additional service to help with capacity. First, prepare your cab ready for departure here at Lincoln. You'll be running empty to Nottingham and then return with 1Z12 which is a non-stop run between Nottingham and Lincoln. Have a safe trip!

Difficulty: Medium | Duration: 115 minutes

[Default] 1B81 07:30 Lincoln – London Kings Cross

Drive a High Speed Train on the morning southbound Lincoln to London Kings Cross service.

Difficulty: Easy | Duration: 27 minutes

Free Roam scenarios

Pick a train and explore the route!

Lincoln Free Roam

Newark Northgate Free Roam

Nottingham Free Roam

QUICK DRIVE

This route is equipped for use with the Quick Drive option in Train Simulator.

To access this option from the Main Menu, press the 'Drive' button and then the 'Quick Drive' tab at the top left.

The Quick Drive menu

The top left area on the menu is where you select the train you wish to drive.

When you click on the menu directly to the right of the train picture, it shows the variations/consists available for the selected train in the right-side area of the menu. Click on the consist that you want to drive.

Changing your train

If you want to drive a different train, click back on the top left train picture. The right side of the menu will change and will display all the trains you have installed in Train Simulator.

Use the 'Page' button located at the top middle of the pictures to scroll through them all.

All installed trains which have Quick Drive enabled are displayed. If the train does NOT have Quick Drive enabled, it will NOT be displayed in the Quick Drive menu.

Selecting your route

When you have selected the train and consist you wish to drive, you then need to select the route.

In the middle left area are the route selection menus. Click on the middle far left route picture. This will change the right-side area of the menu to display the routes that you have installed in Train Simulator.

Choosing departure and arrival stations

Click on the route 'map' image directly to the right of the route picture. This will then show the available departure and arrival points for the route. You can select them by clicking on the ones you want.

Changing the time and weather

Controls for changing the time of day and weather conditions are on the lower left area. You can use these to adjust the time and weather settings as you wish.

Driving

When you have made all your selections, press the 'Drive' button on the lower right side of the menu and Train Simulator will load your settings.

IMPORTANT – Filters

In the Standard and Free Roam ‘Drive’ menus there are various locomotive and route filter options along the top of the right side. We strongly recommend that these are all set to ‘None’ unless you are experienced in using them.

If you set a filter and forget to remove it, there is a strong possibility that not all the available locomotives and/or routes will be displayed in the menu.



CREDITS

Route developers

Mark Walker – track laying and scenery

Thomas Harrison – scenery

Custom objects

Gü Studios – track models

Benedict Cooper, Callum Green, Alexander Penfold, Nitin Singh, William Stead, Tom Williams

Scenarios

Thomas Harrison, Mark Walker, Ashley Clark, Alexander Ray-Webber

Quick Drive scenarios

Benedict Cooper

Just Trains

Project Management	Alex Ford
Installer	Martin Wright
Artwork	Fink Creative
Manual	Alex Ford
Technical Support	Craig Haskell, Mark Allison, Dan Cushing
Customer Service	Simon King

Special thanks to Paul Taylor and EMR driver Kerry Hewitt.

Special thanks also to all the testers.

COPYRIGHT

©2022 Just Trains. All rights reserved. Just Trains and the Just Trains logo are trademarks of JustFlight London Limited, St. George's House, George Street, Huntingdon, PE29 3GH, UK. All trademarks and brand names are trademarks or registered trademarks of the respective owners and their use herein does not imply any association or endorsement by any third party.

Note: One or more textures on some of the 3D models in this product have been created with images from [Textures.com](https://www.textures.com). These images may not be redistributed. Please visit [Textures.com](https://www.textures.com) for more information.

Just Trains' Midland Main Line route and extensions



Midland Main Line: Sheffield-Derby



Derwent Valley Line



*Derby-Nottingham-Leicester
Extension*



Erewash Valley



*Barrow Hill Roundhouse
Extension*

Just Trains™

www.justtrains.net

Just Trains™
www.justtrains.net